



THE

CITADEL

COMMANDING THE CITYSCAPE



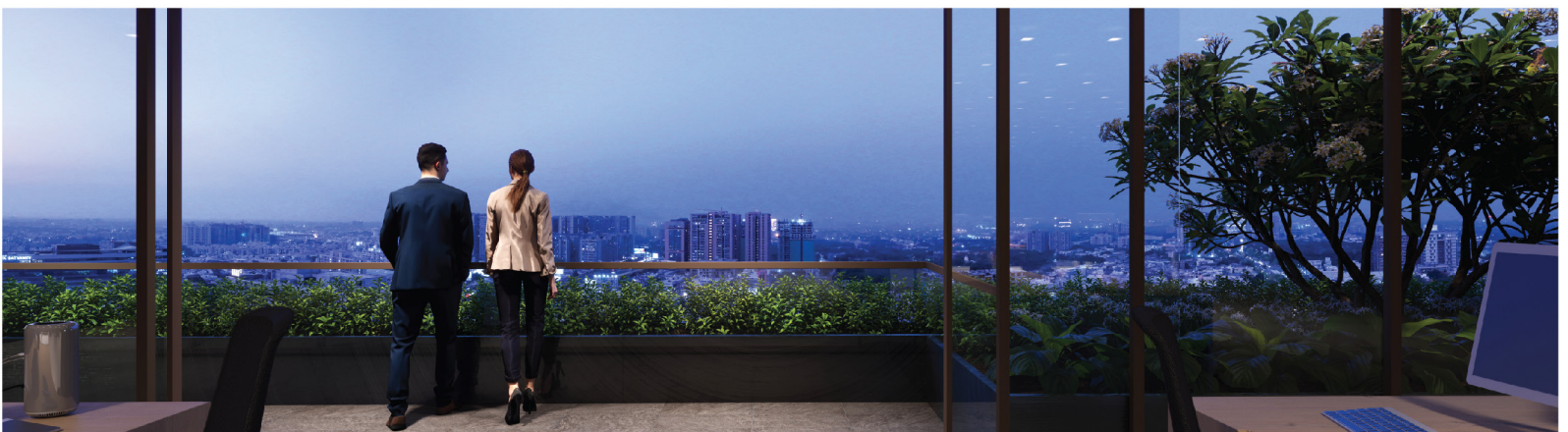

Ground Floor



01	ARRIVAL PLAZA	38'6" X 35'8"
02	VISITOR RESTROOM	
03	BMS OFFICE	12'8" X 8'0"
04	CLOAK ROOM	12'8" X 25'5"
05	RAMP TO BASEMENT	10.00 MT. WIDE
06	DOMESTIC STAFF ZONE	31'8" X 12'10"
06a	STAFF RESTROOM	16'3" X 6'9"
07	LOADING UNLOADING BAY	17'5" X 39'3"
08	LIFT LOBBY	20'7" X 92'7"
09	RECEPTION	17'3" X 11'0"
10	CONFERENCE ROOM	17'0" X 26'0"
11	SEMINAR HALL	17'0" X 33'1"
12	HOLLOW PLINTH	45'4" X 79'5"
12a	SERVICE CORRIDOR / EMERGENCY EXIT	8'4" WIDE
14	RETAIL PASSAGE	6'0" WIDE
15	SECURITY CABIN	

001	SHOWROOM	48'6" X 100'9"
002	SHOWROOM	48'10" X 100'9"

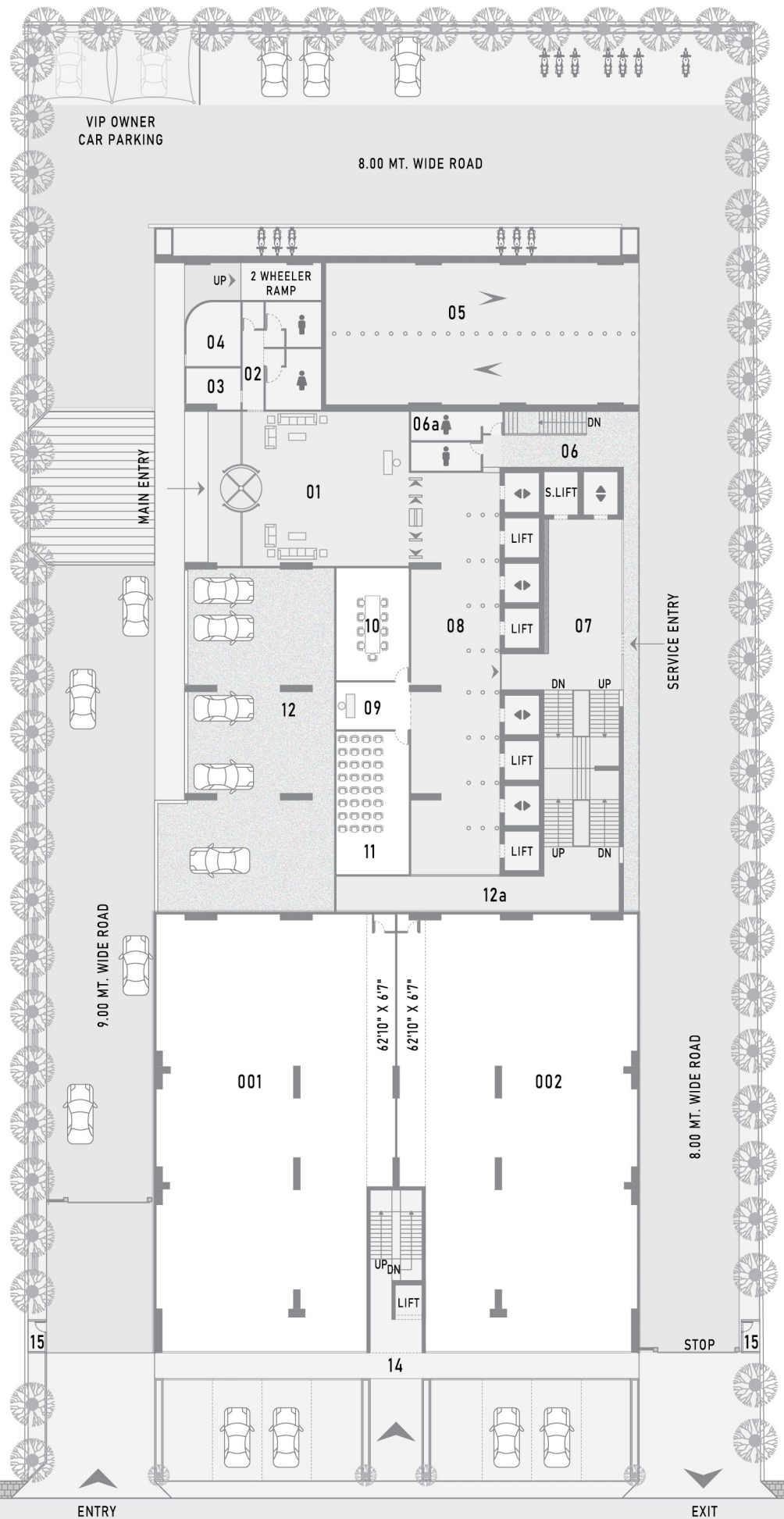

First Floor



01	CAFE	-
02	PROJECTOR SCREEN	-
03	DAY CARE	-
04	INDOOR GAMES	-
05	KITCHEN	27'6" X 17'7"
06	FORMAL A/C DINING	19'8" X 17'7"
07	FOYER	10'0" X 92'7"
08	BREAKOUT ZONE	17'5" X 39'3"
09	SERVICE CORRIDOR	8'4" WIDE
10	RETAIL PASSAGE	6'9" WIDE

101	SHOWROOM	16'0" X 109'5"
102	SHOWROOM	16'0" X 93'0"
103	SHOWROOM	16'0" X 93'0"
104	SHOWROOM	16'0" X 93'0"
105	SHOWROOM	16'0" X 93'0"
106	SHOWROOM	16'3" X 100'9"

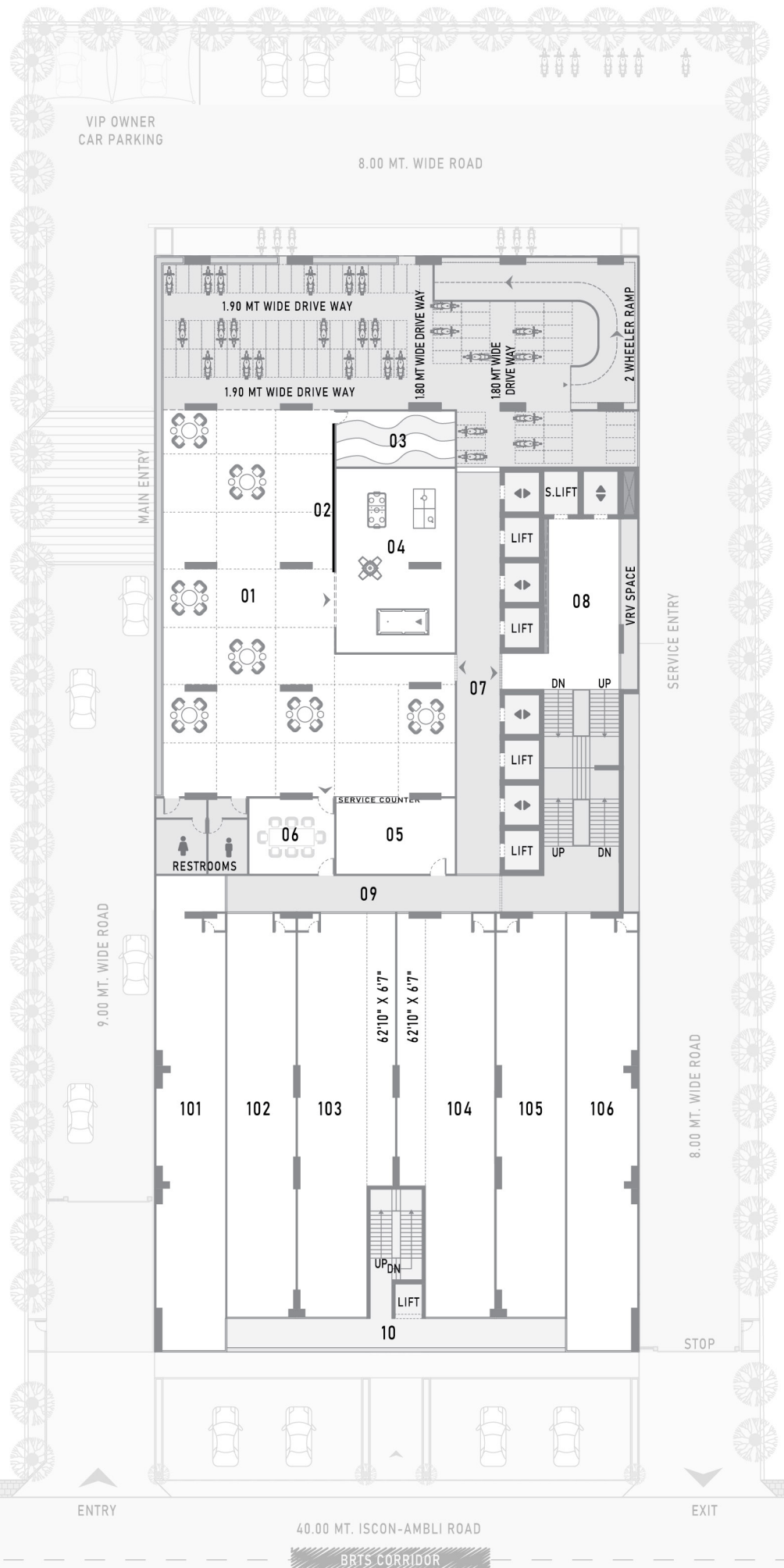

2nd, 8th, 14th Floor Plan



01	OFFICE	31'4" X 100'9"
02	OFFICE	79'3" X 83'10"
03	OFFICE	45'0" X 16'0"
04	OFFICE	45'0" X 13'0"
05	OFFICE	45'0" X 13'0"
06	OFFICE	45'0" X 13'0"
07	OFFICE	45'0" X 13'0"
08	OFFICE	45'0" X 13'0"
09	OFFICE	45'0" X 13'0"
10	OFFICE	45'0" X 18'0"
11	OFFICE	45'0" X 18'0"
12	OFFICE	65'4" X 35'1"
12a	OFFICE	31'4" X 35'1"

14	PASSAGE	13'6" WIDE
15	BREAKOUT ZONE	17'5" X 39'3"

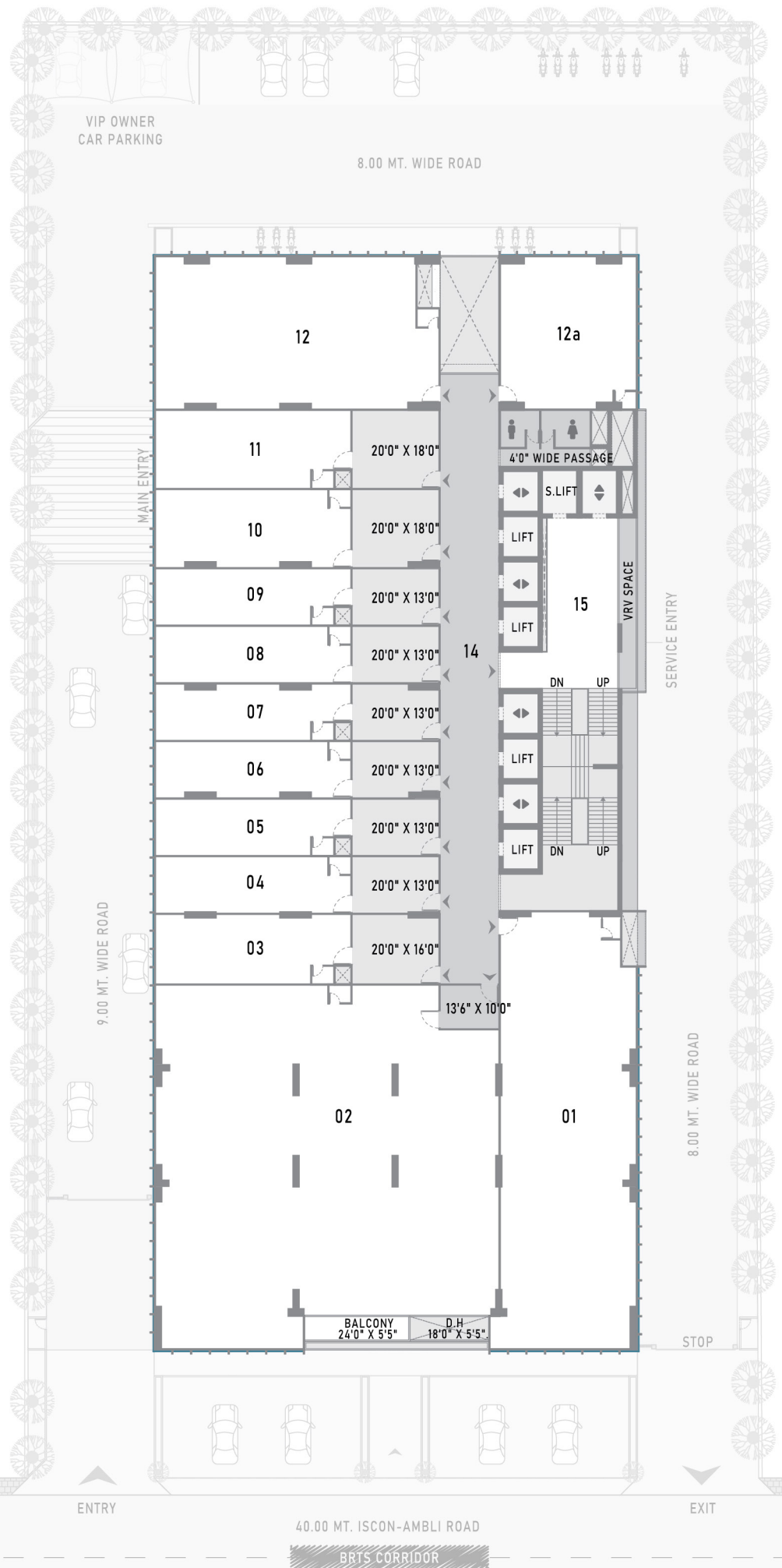

N

3rd, 9th, 15th Floor Plan



01	OFFICE	31'4" X 100'9"
02	OFFICE	79'3" X 83'10"
03	OFFICE	45'0" X 16'0"
04	OFFICE	45'0" X 13'0"
05	OFFICE	45'0" X 13'0"
06	OFFICE	45'0" X 13'0"
07	OFFICE	45'0" X 13'0"
08	OFFICE	45'0" X 13'0"
09	OFFICE	45'0" X 13'0"
10	OFFICE	45'0" X 18'0"
11	OFFICE	45'0" X 18'0"
12	OFFICE	65'4" X 35'1"
12a	OFFICE	31'4" X 35'1"

14	PASSAGE	13'6" WIDE
15	BREAKOUT ZONE	17'5" X 39'3"

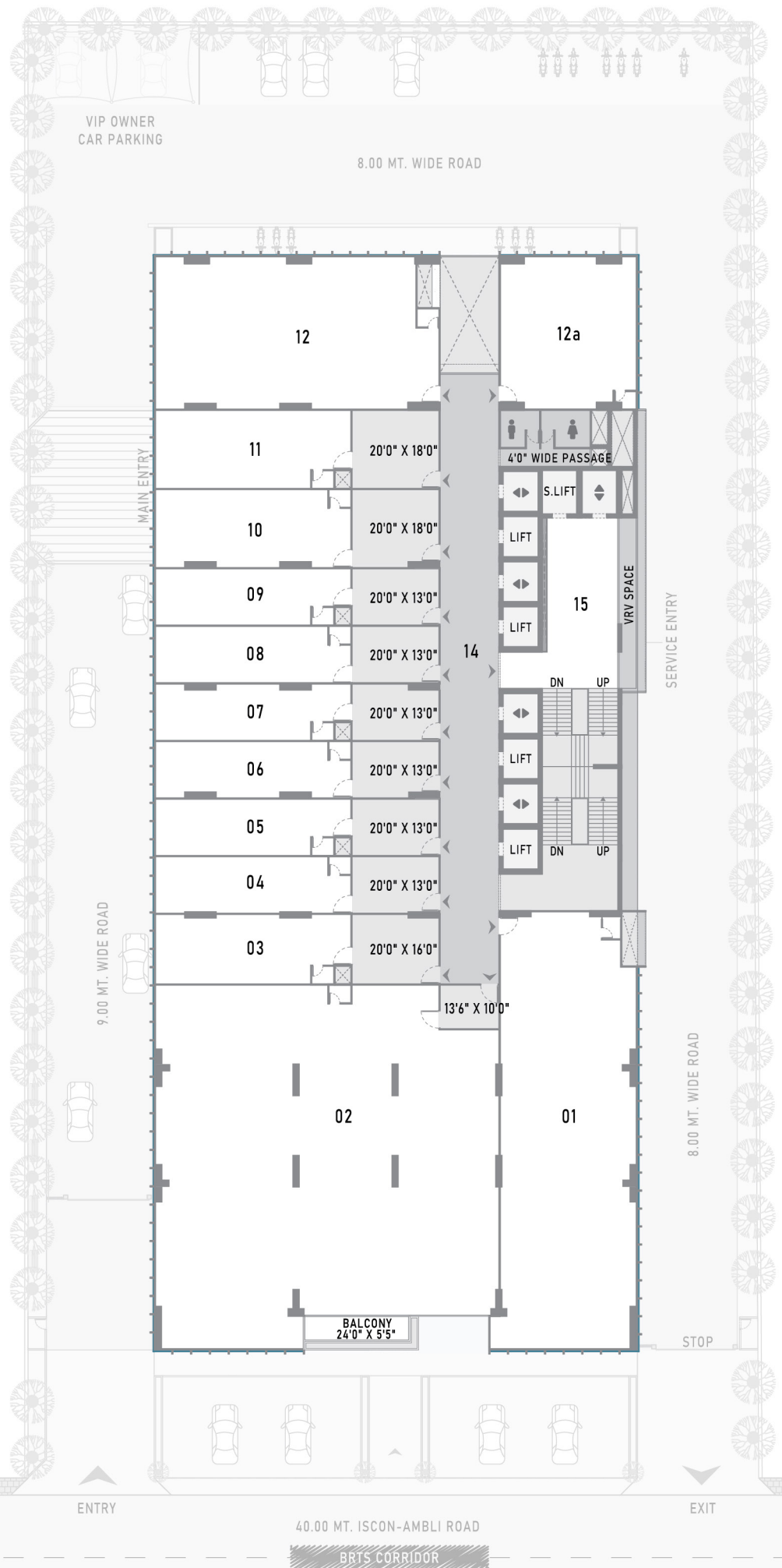

4th, 7th, 10th, 13th, 16th Floor Plan



01	OFFICE	31'4" X 100'9"
02	OFFICE	79'3" X 83'10"
03	OFFICE	45'0" X 16'0"
04	OFFICE	45'0" X 13'0"
05	OFFICE	45'0" X 13'0"
06	OFFICE	45'0" X 13'0"
07	OFFICE	45'0" X 13'0"
08	OFFICE	45'0" X 13'0"
09	OFFICE	45'0" X 13'0"
10	OFFICE	45'0" X 18'0"
11	OFFICE	45'0" X 18'0"
12	OFFICE	65'4" X 35'1"
12a	OFFICE	31'4" X 35'1"

14	PASSAGE	13'6" WIDE
15	BREAKOUT ZONE	17'5" X 39'3"

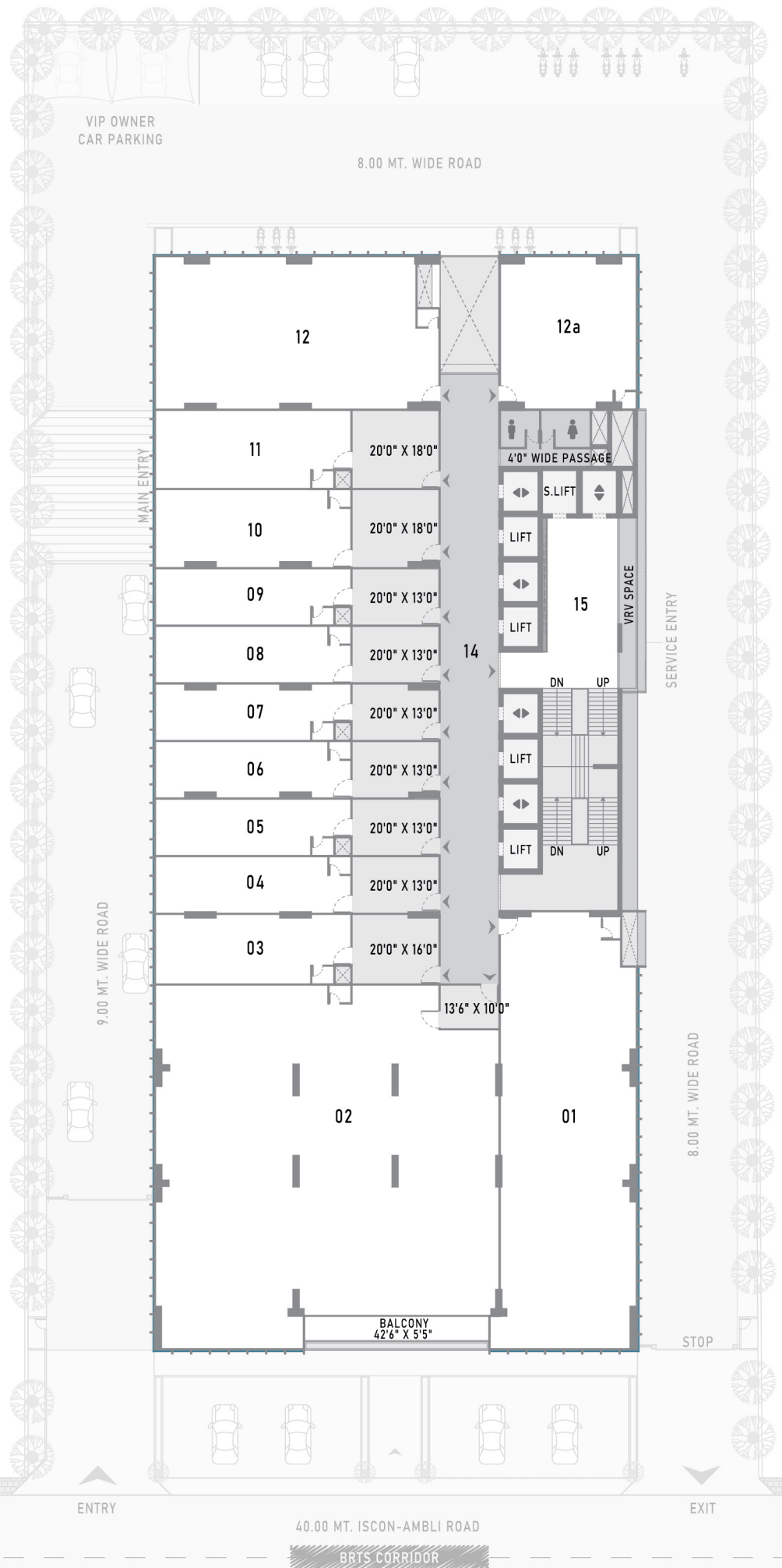

5th, 11th, 17th Floor Plan



01	OFFICE	31'4" X 100'9"
02	OFFICE	79'3" X 83'10"
03	OFFICE	45'0" X 16'0"
04	OFFICE	45'0" X 13'0"
05	OFFICE	45'0" X 13'0"
06	OFFICE	45'0" X 13'0"
07	OFFICE	45'0" X 13'0"
08	OFFICE	45'0" X 13'0"
09	OFFICE	45'0" X 13'0"
10	OFFICE	45'0" X 18'0"
11	OFFICE	45'0" X 18'0"
12	OFFICE	65'4" X 35'1"
12a	OFFICE	31'4" X 35'1"

14	PASSAGE	13'6" WIDE
15	BREAKOUT ZONE	17'5" X 39'3"

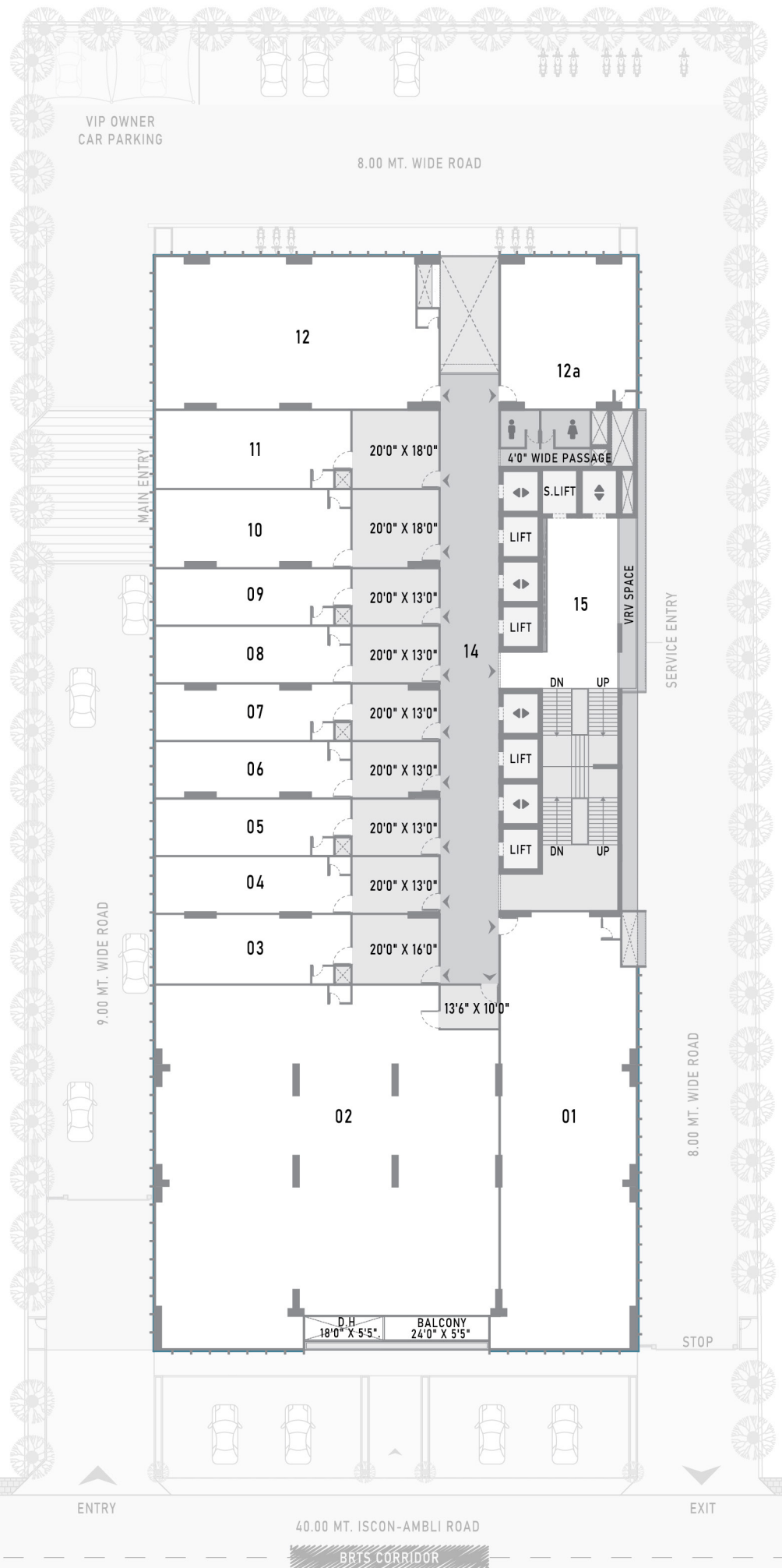

6th, 12th, 18th Floor Plan



01	OFFICE	31'4" X 100'9"
02	OFFICE	79'3" X 83'10"
03	OFFICE	45'0" X 16'0"
04	OFFICE	45'0" X 13'0"
05	OFFICE	45'0" X 13'0"
06	OFFICE	45'0" X 13'0"
07	OFFICE	45'0" X 13'0"
08	OFFICE	45'0" X 13'0"
09	OFFICE	45'0" X 13'0"
10	OFFICE	45'0" X 18'0"
11	OFFICE	45'0" X 18'0"
12	OFFICE	65'4" X 35'1"
12a	OFFICE	31'4" X 35'1"

14	PASSAGE	13'6" WIDE
15	BREAKOUT ZONE	17'5" X 39'3"

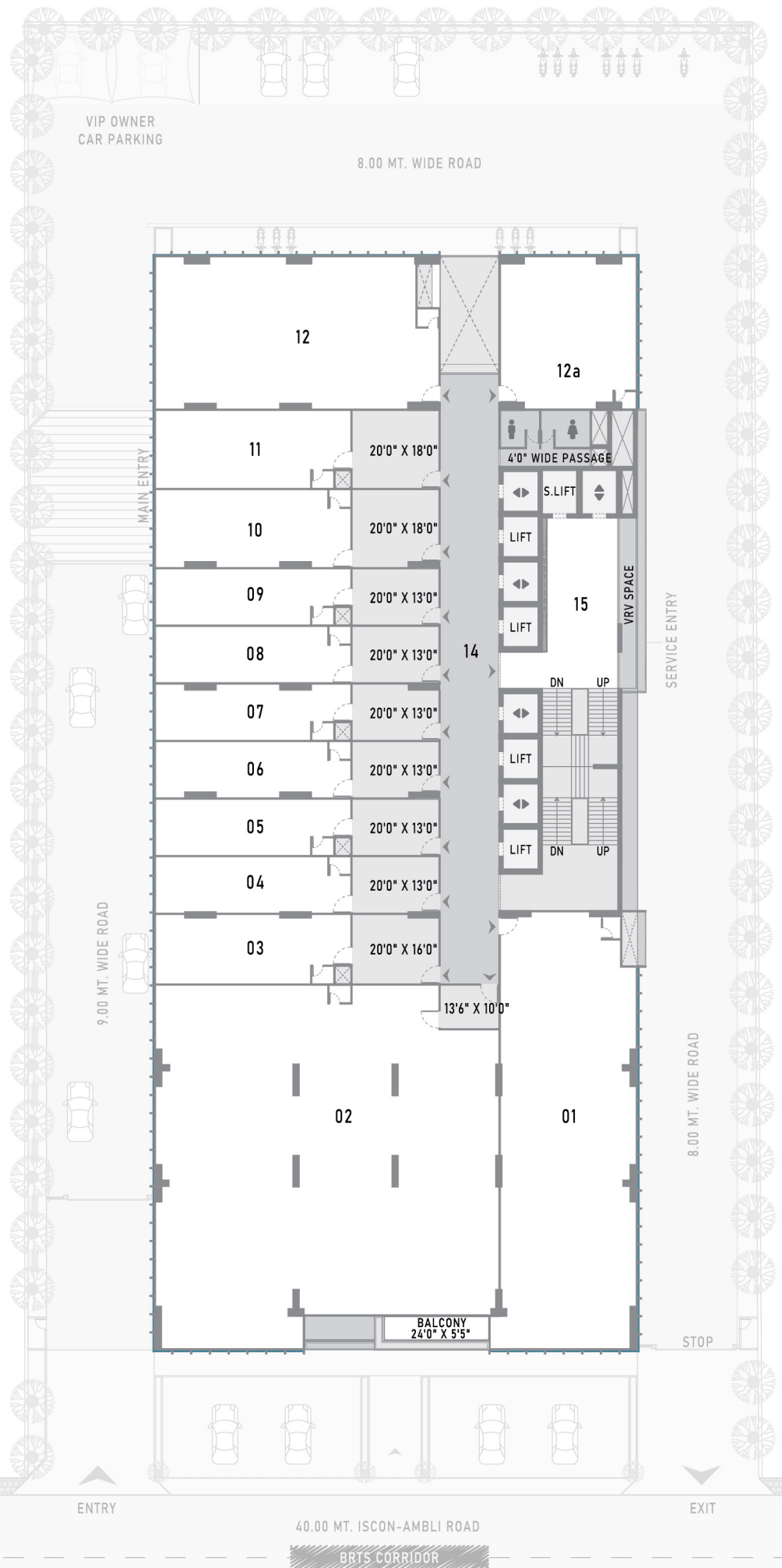

19th Floor Plan



01	OFFICE	31'4" X 100'9"
02	OFFICE	79'3" X 46'4"
02a	OFFICE	34'1" X 37'6"
03	OFFICE	45'0" X 16'0"
04	OFFICE	45'0" X 13'0"
05	OFFICE	45'0" X 13'0"
06	OFFICE	45'0" X 13'0"
07	OFFICE	45'0" X 13'0"
08	OFFICE	45'0" X 13'0"
09	OFFICE	45'0" X 13'0"
10	OFFICE	45'0" X 18'0"
11	OFFICE	45'0" X 18'0"
12	OFFICE	65'4" X 35'1"
12a	OFFICE	31'4" X 35'1"

14	PASSAGE	13'6" WIDE
15	BREAKOUT ZONE	17'5" X 39'3"

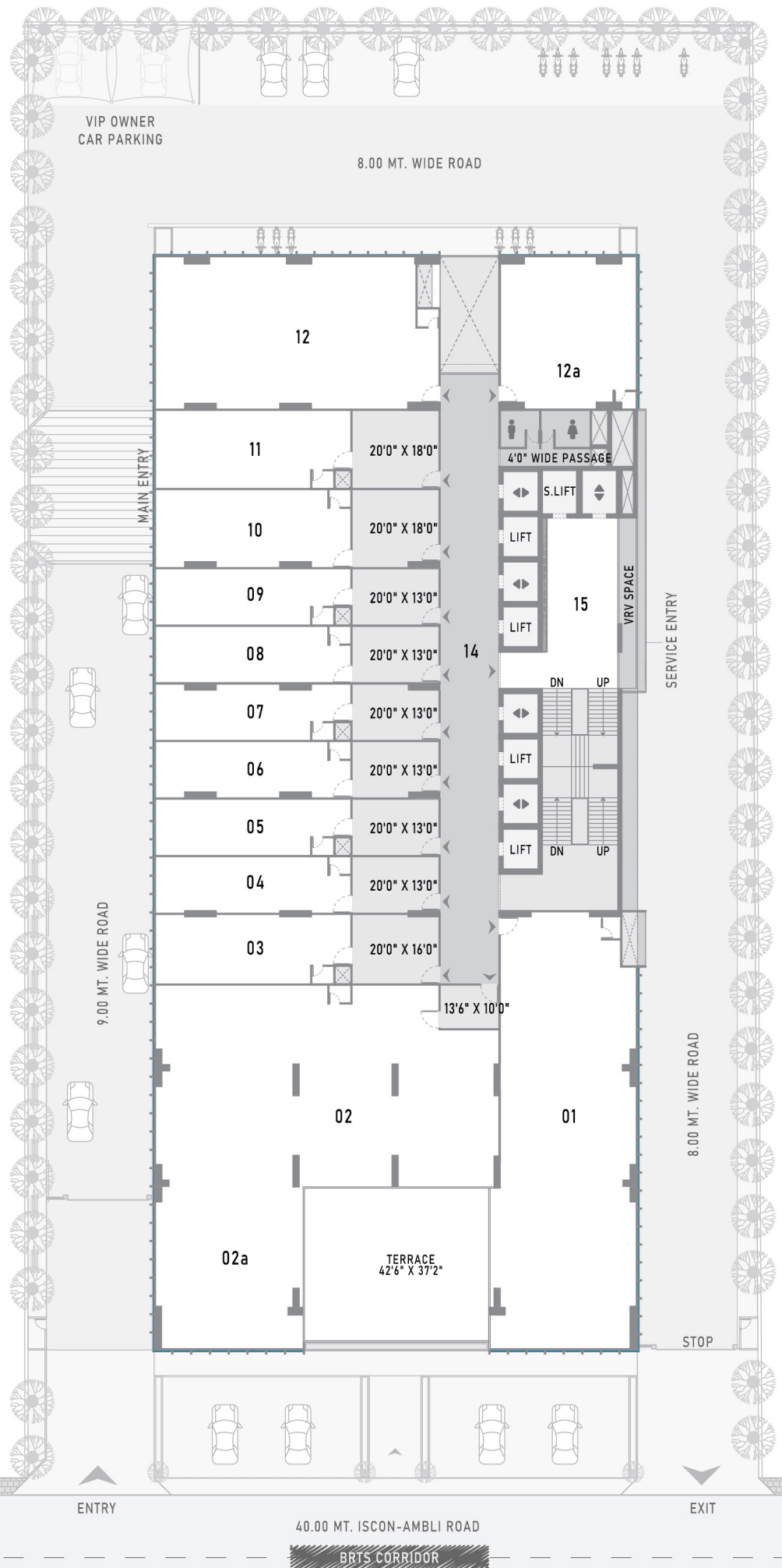

Basement 1



40.00 MT. ISCON-AMBLI ROAD

BRTS CORRIDOR



N

Basement 2

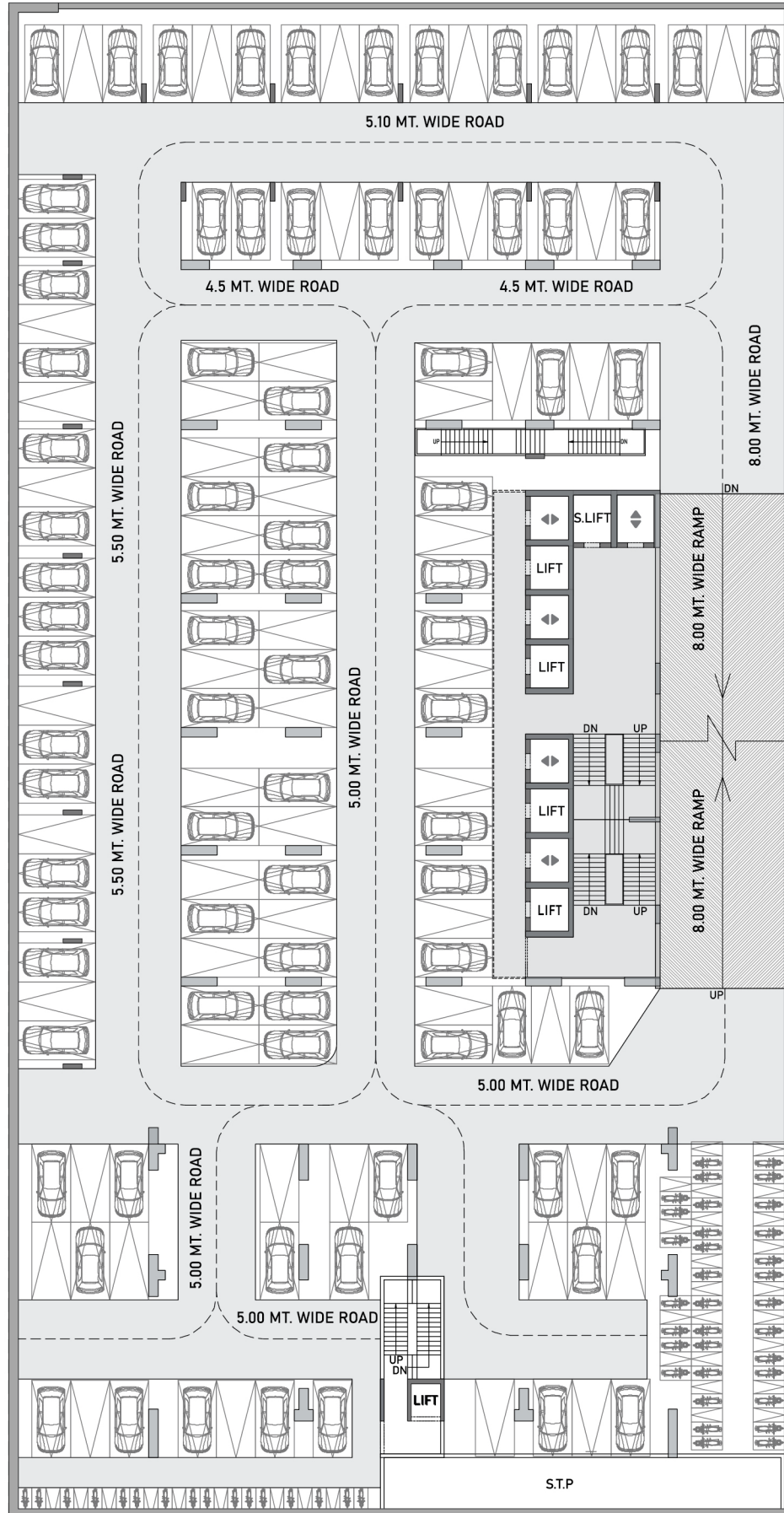

40.00 MT. ISCON-AMBLI ROAD

BRTS CORRIDOR



Basement 3

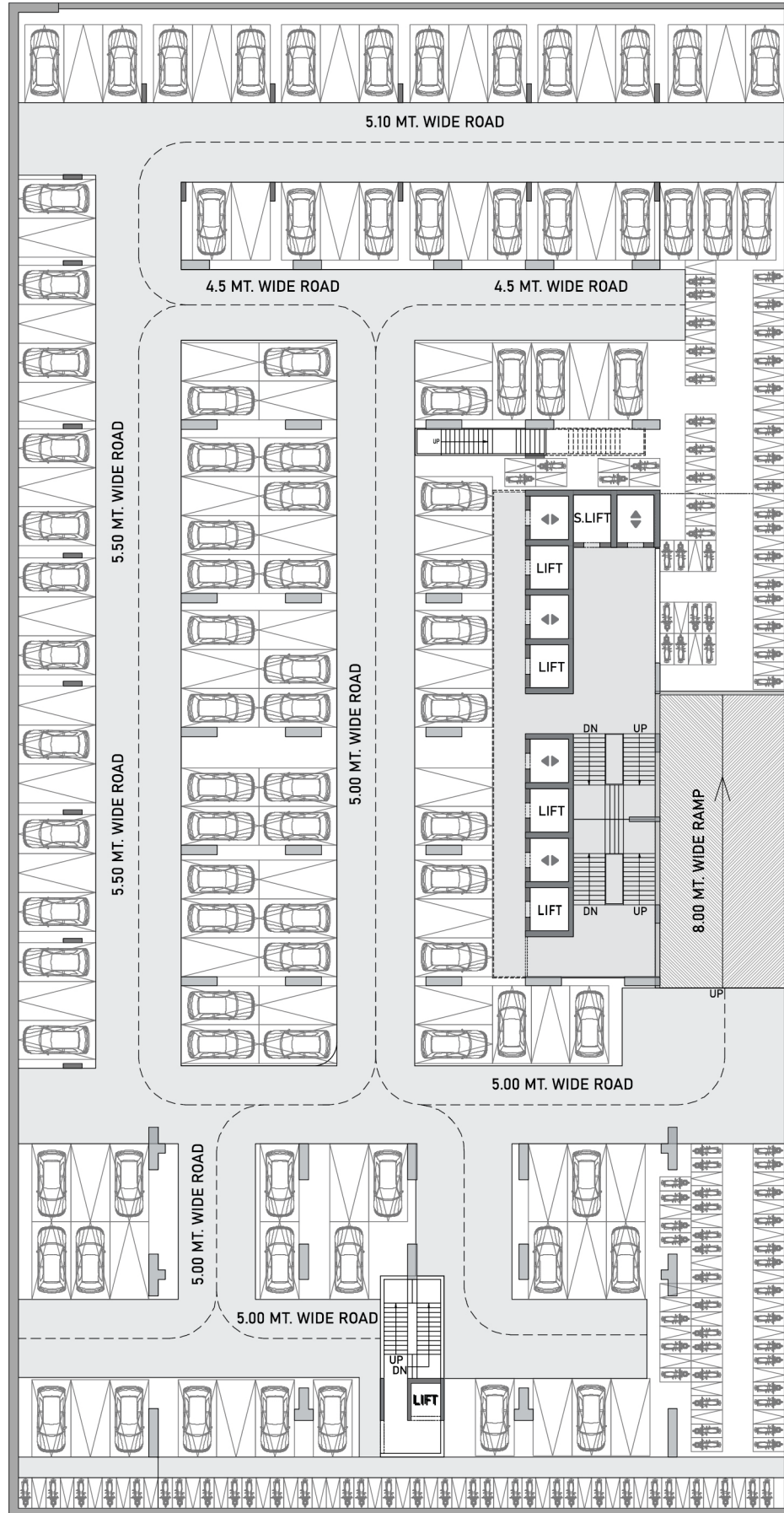

40.00 MT. ISCON-AMBLI ROAD

BRTS CORRIDOR



Specifications



Façade

- Saint Gobain, AIS or Equivalent Manufactured Reflective Toughened Glasses

Plumbing

- Personal Toilets In Every Shops/Offices
- Sanitary Wares - CERA Or Equivalent
- Toilet Fittings - Jaguar Or Equivalent
- Good Quality UPVC Pipes
- Under Ground & Overhead Water Tank, With Automatic Supply System
- Designated Plumbing Duct/Area Provided For Each Unit

Electric

- AYFY Cable
- Concealed Wiring In Each Unit
- Sufficient Power In Each Unit (Depending Upon Size Of Unit) With Sufficient Electrical Points.
- Sufficient Ambient LED Lights For Passages

Air-Conditioning

- Provision To Keep Outdoor AC Unit On Designated Platform
- Provision Of Drain (For HAVC) Has Been Provided

Anti Termite Treatment

- Thorough Anti Termite Treatment Has been Carried Out

Flooring

- Office-Vitrified Tiles (2' X 2')
- Passage & Lift Lobby - Vitrified Tiles & Granite

Finishing

- All Internal Wall Nicely Finished
- All External Wall With Acrylic Paint

Elevators

- 8 Destination Control Elevator
- 2 Service Elevator

Shutters/Doors

- Good Quality Shutters/Doors With Oil Paint

Security

- CCTV Cameras At Designated Locations
- Manned Security For Building Gated Entry, Controlled Access Of Vehicles

Signage And Name Plate

- Pre-Defined Spaces For Signage And Hoardings

Telephone/Internet/Wi-Fi

- Major Telecom Companies To Provide Wire, & Wireless Internet & Telephone Services

Multilevel Car Parking Provision In All 3 Basements

Disclaimer: All the architectural and interior images in the brochure are merely simulated interpretations using computer graphics to enhance the customer understanding and are not factual images. The colour and general appearance of the flooring and wall tiles, sanitary ware & fitting walls, ceilings, windows, doors, internal roads, trees, shrubbery etc. Shown in the simulated computer graphics images are taken from the object libraries for the purpose of presentation and the prospective buyers of the concerned property are advised to refer to the constructor specifications. Additional amenities and/or utilities not mentioned or shown in the brochure but may be required as per the law should be deemed to be forming part of the project by the purchaser. All furniture including wardrobes, other sofa furnishings inter-alia curtains, mattresses, bed, linen, upholstery etc. Lights and other electrical fixtures and appliances like air conditioners, refrigerators, TVs, telephones, laptops etc.. Any of the equipment household accessories inter-alia crockery and cutlery, rugs, carpets, decorative pieces and wall hangings, wall papers, utensils etc. Apparels and all other consumable and movable items shown in the simulated images do not form part of the sale of any property by the developer. All rights reserved with the developers to make any changes in THE CITADEL as deemed necessary and all the members shall abide by such changes. Gst, stamp duty, registration charges, or any other charges and taxes as & when levied by government or any of its body shall be borne by purchaser/buyer/legal possession holder. This brochure is not to be treated as part of the legal document and is for an easy display of the project subject to Ahmedabad jurisdiction only. The brochure is for restricted private circulation only and is not to be considered as a legal document with obligations for specific performance. It is meant for the purpose of conceptual presentation only.



DEVELOPER



ARCHITECT



STRUCTURE DESIGN



MEPF\BIM



VASTU CONSULTANT



Rera Registration No. PR/GJ/AHMEDABAD/DASKROI/Ahmedabad Municipal Corporation/CAA14269/171024/311229. | www.gujrera.gujarat.gov.in
 For Contact E-mail: thecitadelamd@gmail.com. CALL: +91 75671 41774 | 75671 37086
 Site Address: The Citadel, Opp. Bopal Approach BRTS, Iscon-Ambli Road, Ambli, Ahmedabad, Gujarat-380058